

AREA STATEMENT
 PLOT AREA= 200.0 SQ.M.
 PERMISSIBLE :
 GROUND COVERAGE 65% = 130.0 SQ.M.
 F.A.R.-2.5

PERMISSIBLE :
 MANDATORY OPEN SPACE :
 F.O.S.- 0.75 M. , S.O.S.(1)- 0.9 M.
 S.O.S.(2) - 1.2M. , R.O.S.- 3.0 M.

PROPOSED AREA :
 TYPICAL FLOOR (1ST & 2ND) :
 BUILT UP:122.06 SQ.M. = 1313.85 SQ.FT.

CARPET AREA OF FLAT: 89.69 SQ.M.=965.42 SQ.FT
 BALCONY AREA: 1.81+4.19 =6.00 SQ.M.=64.58 SQ.FT

TYPICAL FLOOR PLAN (1ST AND 2ND)

PROPOSED G+IV RESIDENTIAL BUILDING AT PREMISES NO.
 08-0641 PLOT NO : 1480 IN AA-IIB AT NEW TOWN, KOLKATA.

CLIENT: DANISH CONSTRUCTION

Consultant :



Architecture, planning, interior, engineering

City office
 DD-185, Street no 295,
 New Town, Kolkata-700156
 Contact: 033-40061113

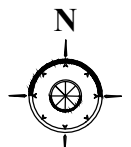

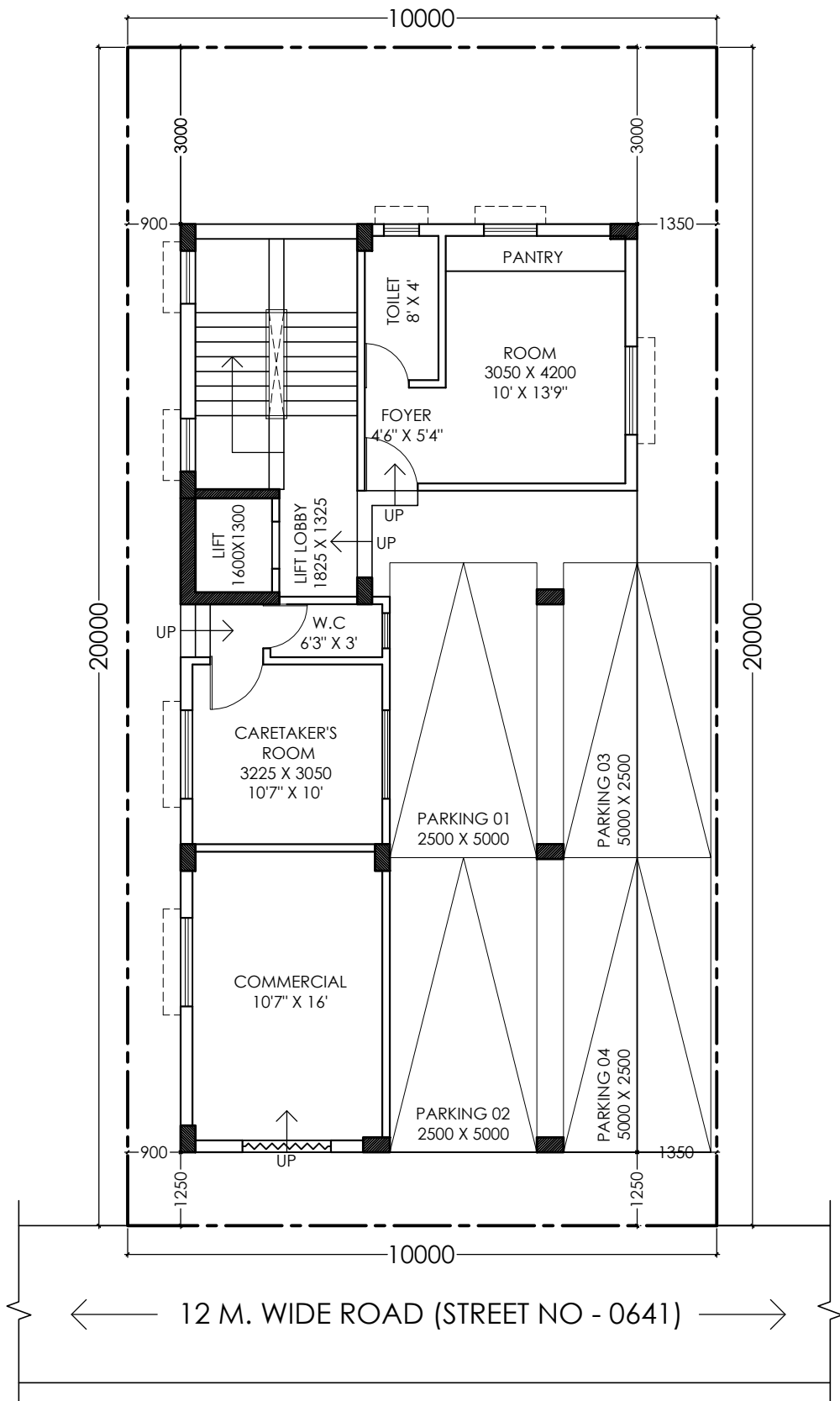

AREA STATEMENT
 PLOT AREA= 200.0 SQ.M.
 PERMISSIBLE :
 GROUND COVERAGE 65% = 130.0 SQ.M.
 F.A.R.-2.5

PERMISSIBLE :
 MANDATORY OPEN SPACE :
 F.O.S.- 0.75 M. , S.O.S.(1)- 0.9 M.
 S.O.S.(2) - 1.2M. , R.O.S.- 3.0 M.

PROPOSED AREA :
 GROUND FLOOR : 122.06 SQ.M. = 1313.85 SQ.FT.

GROUND FLOOR PLAN

PROPOSED G+IV RESIDENTIAL BUILDING AT PREMISES NO.
 08-0641 PLOT NO : 1480 IN AA-IIB AT NEW TOWN, KOLKATA.

CLIENT: DANISH CONSTRUCTION

Consultant :



Architecture, planning, interior, engineering

City office
 DD-185, Street no 295,
 New Town, Kolkata-700156
 Contact: 033-40061113

