

AREA STATEMENT

PLOT AREA = 400.08 SQ.M.

PERMISSIBLE :

GROUND COVERAGE 55% = 220.04 SQ.M.

F.A.R.-2.5

PERMISSIBLE :

MANDATORY OPEN SPACE :

F.O.S.- 1.2 M. , S.O.S.(1)- 1.2 M.

S.O.S.(2) - 2.4M. , R.O.S.- 3.5 M.

PROPOSED AREA :

TYPICAL FLOOR (1ST TO 4TH) : = 219.85 SQ.M.
= 2366.46 SQ.FT.

TYPE A : 101.55 SQ.M. = 1093.08 SQ.FT.

TYPE B : 101.55 SQ.M. = 1093.08 SQ.FT.

TYPICAL FLOOR PLAN (1ST TO 4TH)

PROPOSED G+IV RESIDENTIAL BUILDING AT PREMISES NO. 16-0167 PLOT NO. BF-92 IN AA-IB OF NEW TOWN, KOLKATA.

CONSULTANT :



Architecture, planning, interior, engineering

City office-
DD-185, Street no 295,
New Town, Kolkata-700156
Contact: 033-40061113

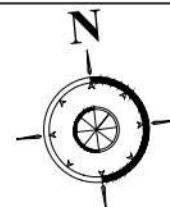

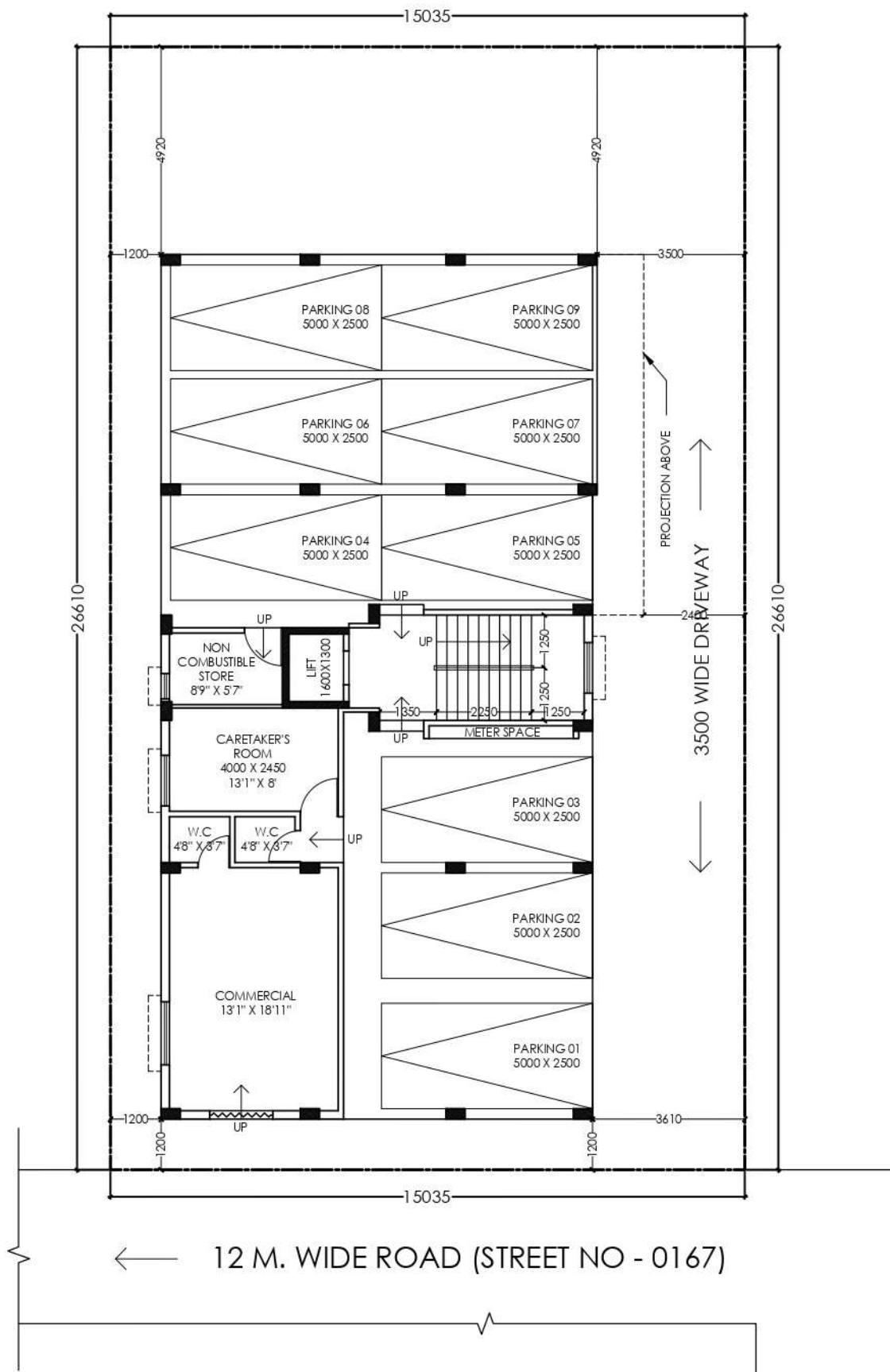

AREA STATEMENT

PLOT AREA = 400.08 SQ.M.

PERMISSIBLE :

GROUND COVERAGE 55% = 220.04 SQ.M.

F.A.R.-2.5

PERMISSIBLE :

MANDATORY OPEN SPACE :

F.O.S.- 1.2 M. , S.O.S.(1)- 1.2 M.

S.O.S.(2) - 2.4M. , R.O.S.- 3.5 M.

PROPOSED AREA :

GROUND FLOOR : = 210.45 SQ.M.

= 2265.28 SQ.FT.

GROUND FLOOR PLAN

PROPOSED G+IV RESIDENTIAL BUILDING AT PREMISES NO. 16-0167 PLOT NO. BF-92 IN AA-IB OF NEW TOWN, KOLKATA.

CONSULTANT :



Architecture, planning, interior, engineering

City office-
DD-185, Street no 295,
New Town, Kolkata-700156
Contact: 033-40061113

